

INSTALLATION GUIDE

follow the instructions correctly for best results .

package contains :

1 snail device .

4 screws for wooden door.

4 screws for metal door.

The "SNAIL" can be installed on both sides of the door.

- Take the device and screws out of their packages.
- Open the door to the center of its opening range .
- Place the device about 5 inches from the lock side of the door . make sure that the wheel is placed on the ground.
- Mark the location of the holes on the door.
- Screw the 4 screws through the device holes to the door.
Make sure that the door is stable while screwing.
- For metal doors use drilling screws.
- Pull out the safety pin from the device.

Your device is ready to use and your door is much safer .

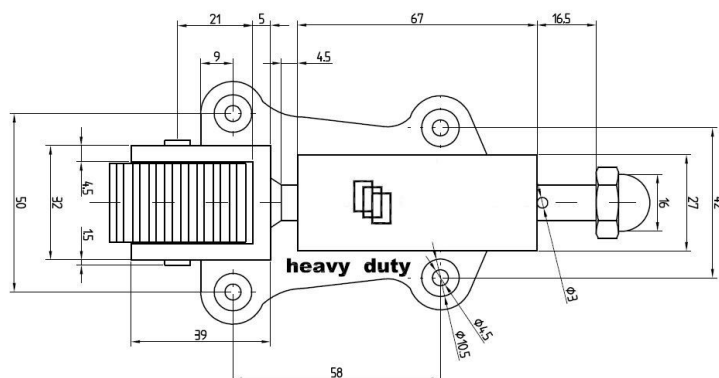

www.guardex-usa.com